

CHARLES L. TATE, JR. AND ASSOCIATES

CONSULTING FORESTER AND REAL ESTATE BROKER

POST OFFICE BOX 668
LAKE WACCAMAW, NORTH CAROLINA 28450

TELEPHONE: 910-646-3764

FAX: 910-646-4429

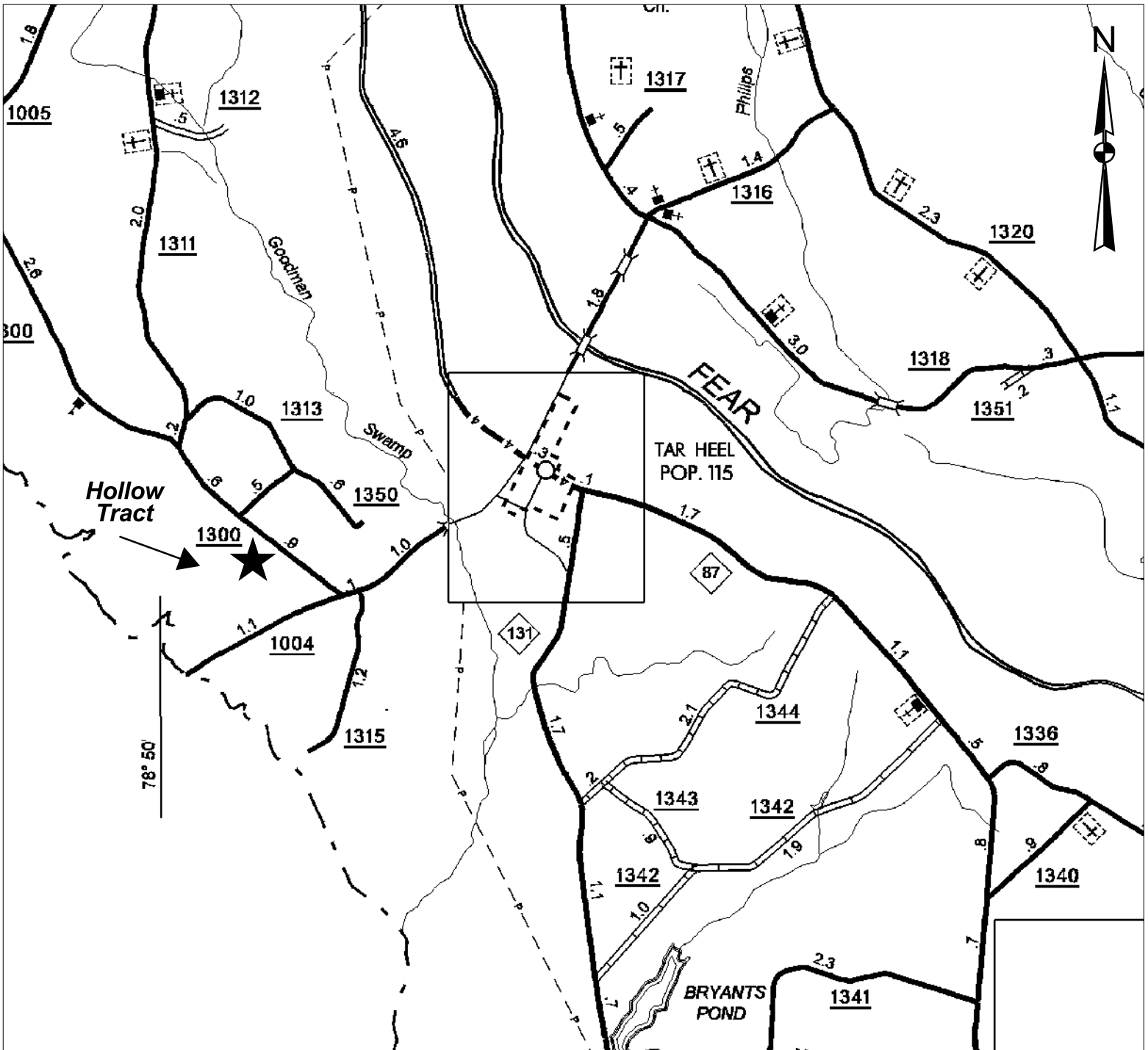

LEGEND	
TRACT BOUNDARY	—————
TIMBER TYPE BOUNDARY	- - - - -
PUBLIC ROAD	===== =====
PRIVATE ROAD	- - - - -
RAILROAD	————— —————
POWERLINE	————— + + + + + —————
CREEK	~~~~~
CANAL / DITCH
BUILDINGS	■ ■ ■ ■ ■

HOLLOW TRACT

COUNTY: BLADEN

TOWNSHIP: HOLLOW

SCALE: 1" = 660 FEET

ACRES: 11.24